

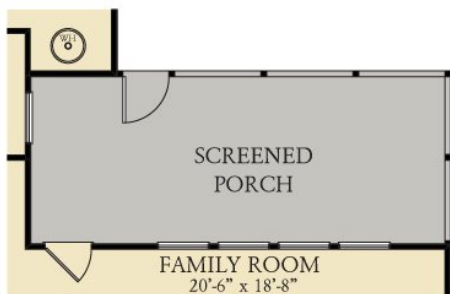

HENLEY II

Approx. 2,065 Total Heated Sq. Ft.
 -3 Bedroom/2 Bathrooms
 -2 Car Garage
 -Owners Suite
 -1 Level



OPTIONAL SCREENED PORCH

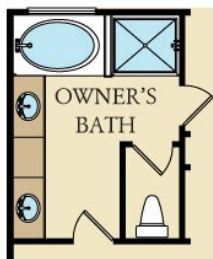

OPTIONAL OWNER'S BATH

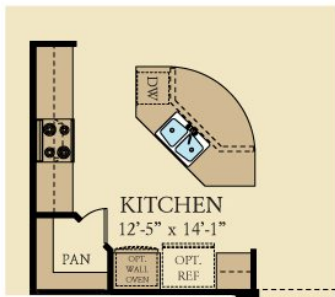

OPTIONAL GOURMET KITCHEN



Elevations of a home may vary and we reserve the right to substitute and/or modify design and materials, to our own discretion and without notice. Please refer to your sales contract/agreement for additional information, disclosures and disclaimers related to the home and its features. Plans are artists renderings and may contain options which are not standard on all models. Streamline Developers reserves the right to make changes to plans and elevations without prior notice. Stated dimensions and square footages are approximations and should not be used as representation of the homes precise or actual size. Any statement, verbal or written, regarding 'under air' or 'finished area' or any other description or modifier of the square footage size of any home is a shorthand description of the manner in which the square footage was estimated and should not be construed to indicate certainty. Garage sizes may vary from home to home and may not accommodate all vehicles. This is not an offer in states where prior registration is required. Void where prohibited by law. All rights reserved. Copyright © 2019 Streamline Developers, LLC. Streamline Developers logo and 'Building Your Dreams are US registered trade/service-marks.